

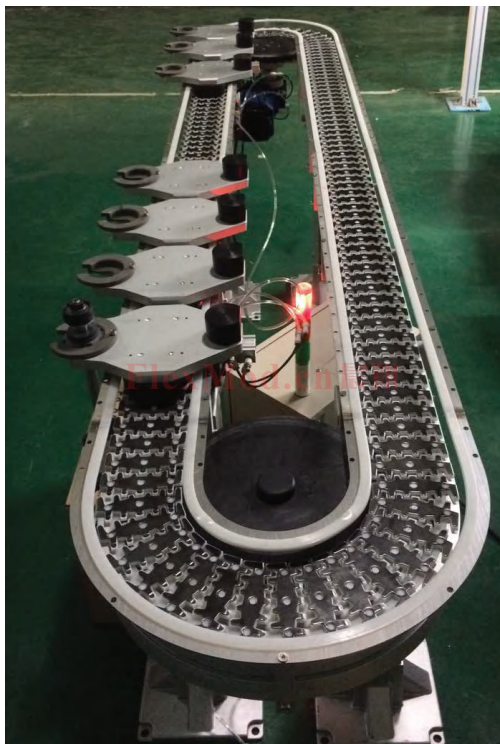

卡通箱输送案例



轴承行业输送案例



托盘环形输送案例

Contents (目录)	2	Examples of application (应用场合)	18
Chains (链条)	2		
Conveyor beam (输送梁)	5		
Idler end units (从动单元)	10		
Horizontal wheel bends (水平轮弯头)	11		
Horizontal plain bends (水平弯头)	13		
Vertical bends (垂直弯头)	15		
Guide rail brackets (导轨支架)	17		



Chain width 295 mm (链宽295mm)



Technical characteristics (技术指标)

Chain tension limit (链条张力极限)2500 N
Beam width (型材宽度)105 mm
Chain width (链条宽度)102 mm
Chain pitch (链条节距)38.1 mm
Item width (输送物品宽度)50-300 mm
Maximum item weight (输送物品重量)	
Horizontal transport (水平传送)30 kg
Vertical transport (垂直传送)15 kg
Maximum weight on conveyor (线体最大承载)800 kg
Maximum conveyor length (线体最大长度)40 m

Examples of application

Ball and roller bearings, heavy boxes, gear wheels, motor parts on pallets, disk brakes, hydraulic pumps.

应用场合

滚珠轴承、齿轮、大型电表、重型开关、液压泵、汽车零部件、工装托盘等。

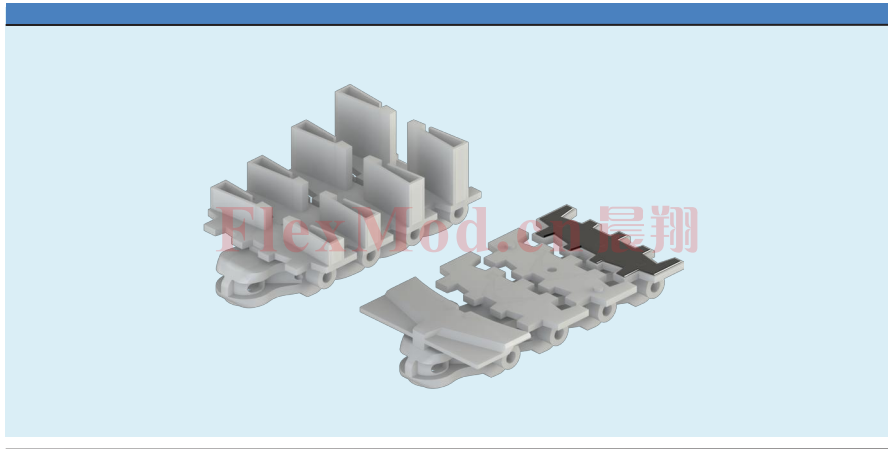

Plastic chain materials(链板材质)	Performance(特性)	Colour(颜色)
POM	Standard material/标准材料	white/白色
POML	Ultra low wear/超润滑	white/白色
POMA	Abrasion resistance/超耐磨	white/白色
POMC	Chemical resistance/抗腐蚀	yellow/黄色
POME	Conductive material/抗静电	black/黑色
POMK	High temperature resistance/耐高温	yellow/黄色
POMF	Food application/用于食品	white/白色
POMN	Low noise/低噪音	white/白色

Plain chain (平板链)

CXKTP 5 Plain chain (平板链)
Length 5 mt (长度5m)

CXKTL 102 Plain link (平板链节)

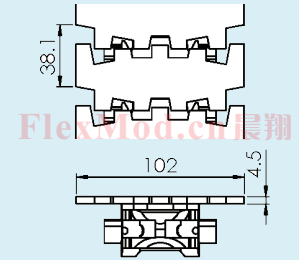

CXKTP 5 A Closed top chain
Length 5 mt (长度5m)

CXKTL 102 Closed link

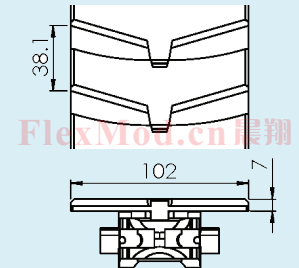
*Universal chain (通用链)*

CXKTF 5 U... Plain chain (平板链)
Length 5 mt (长度5m)

CXKTL 102 U Plain link (平板链节)

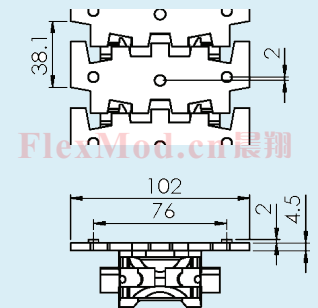

The link has a hole for an M6 screw.
M6 nut will fit inside the link.

Cleated chain (楔链)

Type A
Length 5 mt (长度5m)

CXKTF 5X15 A... H=15 mm

CXKTF 5X20 A... H=20 mm

CXKTF 5X30 A... H=30 mm

CXKTF 5X40 A... H=40 mm

Cleated link(楔链节)

CXKTL 102X15 A H=15 mm

CXKTL 102X20 A H=20 mm

CXKTL 102X30 A H=30 mm

CXKTL 102X40 A H=40 mm

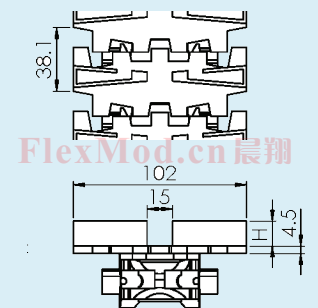

Chains (链条)

FlexMod®

CXKTP 5 TF Plain chain (平板链)
Length 5 mt (长度5m)

CXKTL 102 TF Plain link (平板链节)

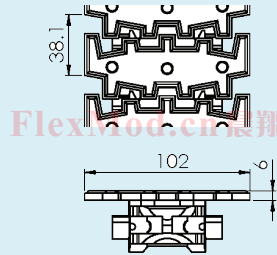

Tools and accessories (工具和附件)

CXKTT 22X24 Plastic pivot (塑料珠)

CXKTD 8X62 Steel pin (钢销)

CXKMJ 8 Pin insertion tool (销子安装工具)



CXK-4

Conveyor beam (输送梁)

FlexMod®

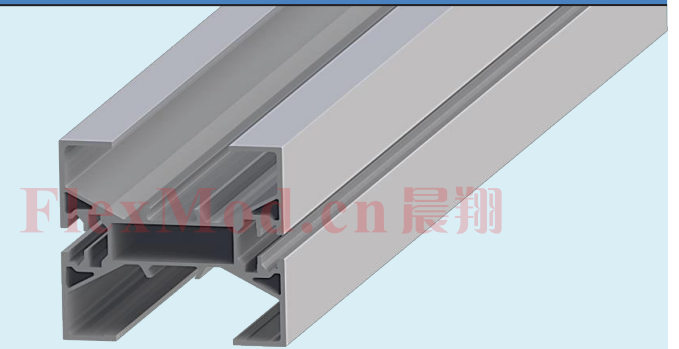

www.flexmod.cn

CXK-5

Conveyor beam (输送梁)

FlexMod®

Beam (输送梁)

CXKCB 3 Length 3 m (长度3m)

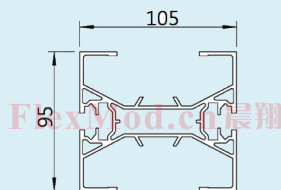

Slide rail Length 25 m (长度25m)
(耐磨条)

CXKCR 25H HDPE+PA6 Gray
CXKCR 25U UHMW White
CXWCR 25P PVDF

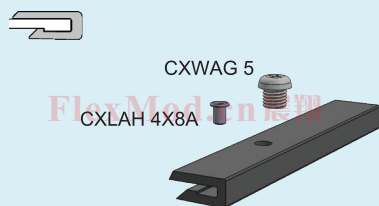

CXLAH 4X8A Aluminium rivet (铝铆钉)

CXWAG 5 Plastic screw (塑料铆钉)

CXKCC 200 Beam section for chain installation
Including connection strips and screws
(链条拆装用活接梁)

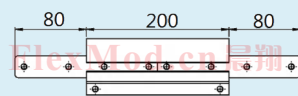

Connecting strip with set screws
(梁体连接条)

CXL CJ 6X160 Length 160 mm
CXL CJ 6X130 Length 130 mm

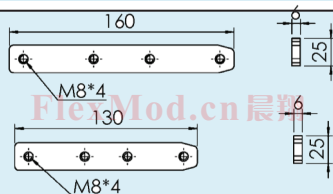

T-slot cover (防尘胶条)

CXCAC 2 Aluminium Length 2 mt
(长度2m)

CXCAC 3P Polyvinyl chloride
Length 3 mt (长度3m)

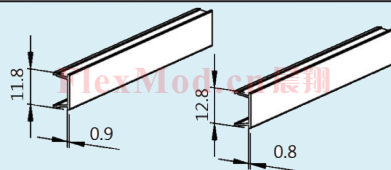

CX3920500 Drill fixture for slide rail
(耐磨条安装工具)

CXKMR 200 Mounting tool (铆钉安装工具)

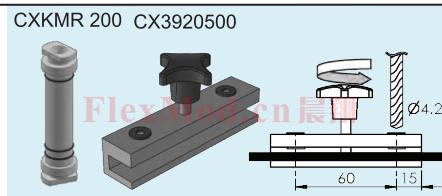

CXK-6

Conveyor beam (输送梁)

FlexMod®

Half beam (半梁)

CXKCB 3H Length 3 m (长度3m)

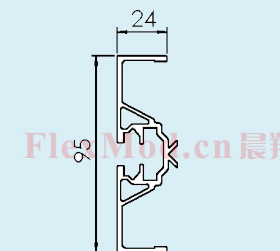

Beam clip (梁夹)

CXKCE 55X30

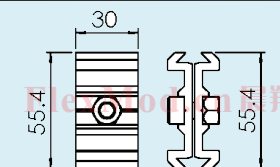

Split Conveyor beam assembled (组合式输送梁)
Length 3 mt (长度3m)

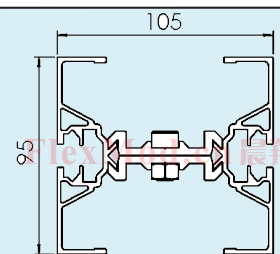

Beam spacer (型材隔条)

CXLCD 3 Aluminium, anodized (阳极处理)
Length 3 mt (长度3m)

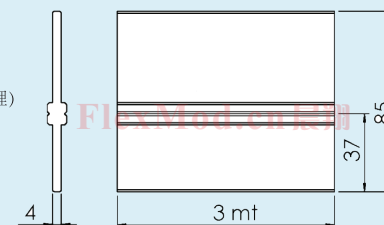

CXS	H=16.0mm
CXL	H=15.9mm
CXM/CX85/CXH	H=10.5mm
CXK	H=0.5mm

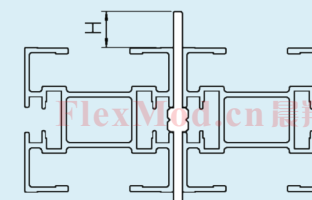

www.flexmod.cn

CXK-7

CXK

Conveyor beam (输送梁)

FlexMod®



FlexMod.cn 晨翔

CXKEB 0HLA Drive unit (驱动单元)
Transmission on left-hand side
(传动装置在左侧)

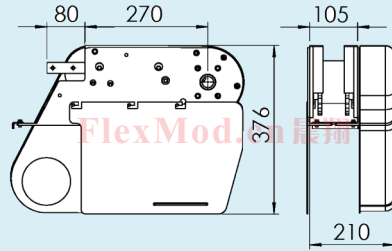

CXKEB 0HRA Drive unit (驱动单元)
Transmission on right-hand side
(传动装置在右侧)

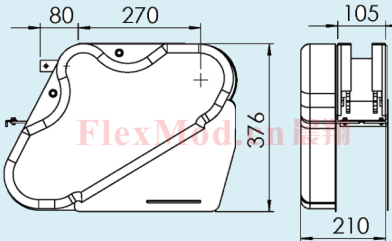

Conveyor beam (输送梁)

FlexMod®



FlexMod.cn 晨翔

CXKEC 0HL Drive unit (驱动单元)
Transmission on left-hand side
(传动装置在左侧)

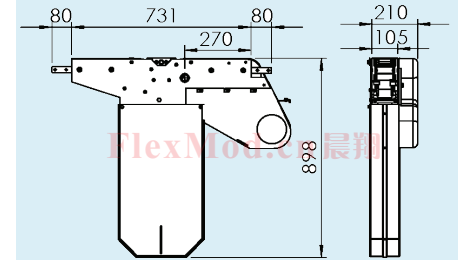

CXKEC 0HR Drive unit (驱动单元)
Transmission on right-hand side
(传动装置在右侧)

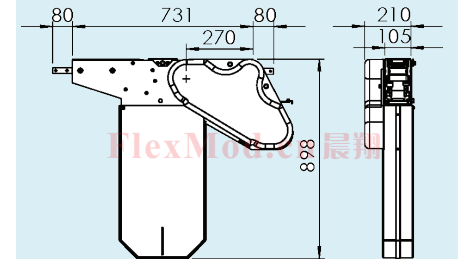

CXK

Idler end units (从动单元)

FlexMod®



CXKEJ 350

Idler end unit (从动单元)

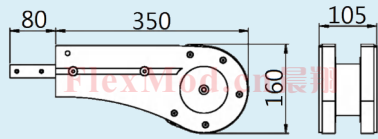

CXK-10

Horizontal wheel bends (水平轮弯头)

FlexMod®



www.flexmod.cn

CXK-11

Horizontal wheel bends (水平轮弯头)

FlexMod®

Horizontal wheel bend, 30° (水平轮弯头30°)

CXKBH 30R200 A Radius to centre of chain 200 mm with protective cover (链条中心半径200mm)

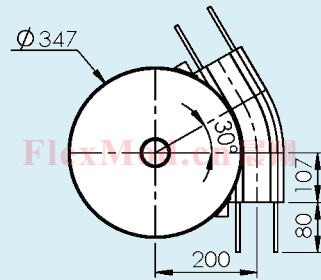

Horizontal wheel bend, 45° (水平轮弯头45°)

CXKBH 45R200 A Radius to centre of chain 200 mm with protective cover (链条中心半径200mm)

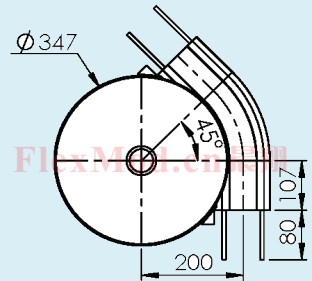

Horizontal wheel bend, 90° (水平轮弯头90°)

CXKBH 90R200 A Radius to centre of chain 200 mm with protective cover (链条中心半径200mm)

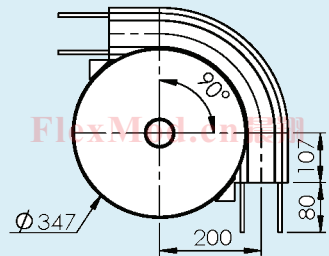

Horizontal wheel bend, 180° (水平轮弯头180°)

CXKBH 180R200 A Radius to centre of chain 200 mm with protective cover (链条中心半径200mm)

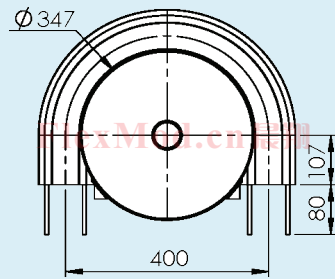

CXK-12

Horizontal plain bends (水平弯头)

FlexMod®



www.flexmod.cn

CXK-13

Horizontal plain bends (水平弯头)

FlexMod®

Horizontal plain bend, 30° (水平弯头30°)
Radius to centre of beam:
(输送梁中心半径)

CXKBP 30R500	R=500 mm
CXKBP 30R700	R=700 mm
CXKBP 30R1000	R=1000mm

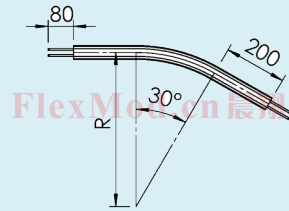

Horizontal plain bend, 45° (水平弯头45°)
Radius to centre of beam:
(输送梁中心半径)

CXKBP 45R500	R=500 mm
CXKBP 45R700	R=700 mm
CXKBP 45R1000	R=1000mm

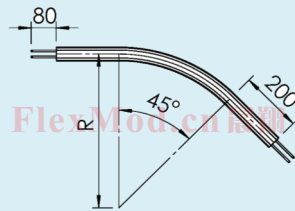

Horizontal plain bend, 60° (水平弯头60°)
Radius to centre of beam:
(输送梁中心半径)

CXKBP 60R500	R=500 mm
CXKBP 60R700	R=700 mm
CXKBP 60R1000	R=1000mm

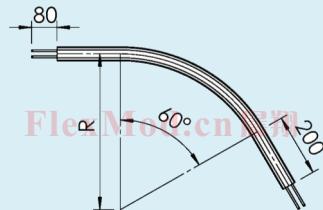

Horizontal plain bend, 90° (水平弯头90°)
Radius to centre of beam:
(输送梁中心半径)

CXKBP 90R500	R=500 mm
CXKBP 90R700	R=700 mm
CXKBP 90R1000	R=1000mm

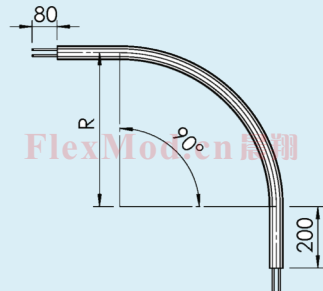

Vertical bends (垂直弯头)

FlexMod®

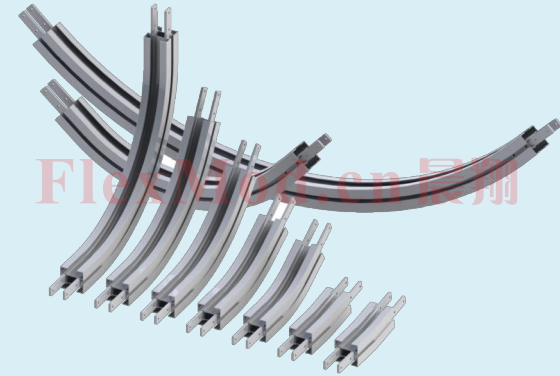

Vertical bends (垂直弯头)

FlexMod®

Vertical bend, 5° (垂直弯头5°)
Radius to centre of beam:
(输送梁中心半径)

CXKBV 5R750 R=750 mm

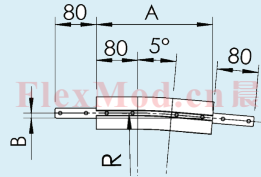

Vertical bend, 15° (垂直弯头15°)
Radius to centre of beam:
(输送梁中心半径)

CXKBV 15R750 R=750 mm

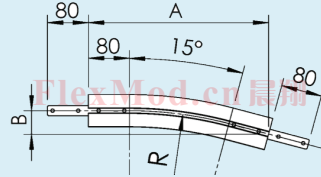

Vertical bend, 30° (垂直弯头30°)
Radius to centre of beam:
(输送梁中心半径)

CXKBV 30R750 R=750 mm

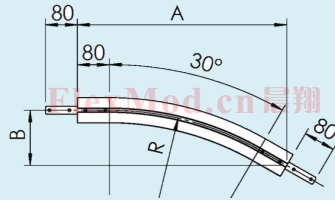

Vertical bend, 45° (垂直弯头45°)
Radius to centre of beam:
(输送梁中心半径)

CXKBV 45R750 R=750 mm

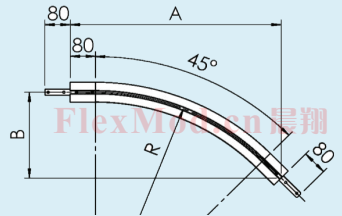

Vertical bend, 90° (垂直弯头90°)
Radius to centre of beam:
(输送梁中心半径)

CXKBV 90R750 R=750 mm

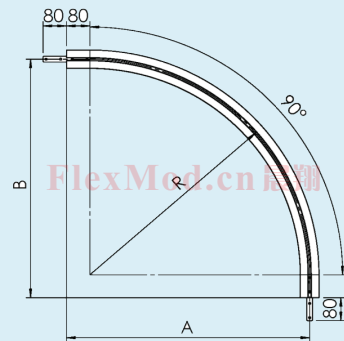

* Note: Special angles on request.

CXK-16

Guide rail brackets (导轨支架)

FlexMod®

CXKRB 30X70 Guide rail bracket for
CXK pallets

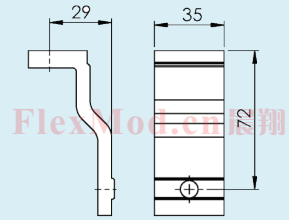

CXKRB 30X74 Guide rail bracket for
CXK pallets

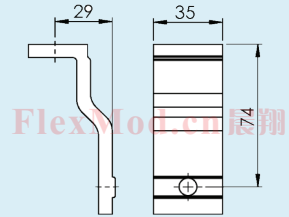

CXLRA 16X30X64

Adjustable guide rail bracket assembly
Including bolt and nut
(可调护栏支架带螺丝)

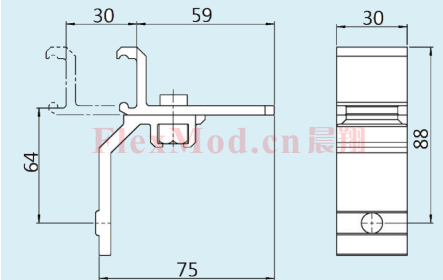

CXK

www.flexmod.cn

CXK-17